

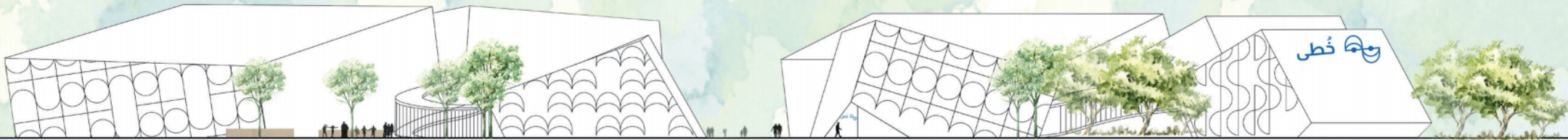

مجتمع رياضي

Community Sport Complex



SAUDI DESIGN
SCALE 1:50

Project Outcome

This project aim to motivate individuals from all backgrounds and abilities to live a healthier life, ncreasing community levels of physical activity and social interaction by providing a healthy environment to practice multiple sports.

Target Audience:

The Residents of the northern region of Jeddah who are interested in sports and healthy lifestyle.

Sustainability Outcomes

RIBA Sustainability Outcomes

- 1 **Reduce inequality**
accesbility to all
- 2 **Ensure healthy lives**
promote well-being for all at all

- 3 **Inclusive socities**
the project serve everyone
- 4 **Achieve gender equality**
facilities specified for women

2030 Vision (Vibrant Society)

- 1 **Life Fulfillment**
social well-being healthy lifestyle

- 2 **Strong Foundations**
empowering health

KSCAU مشاقف المملكة سلاوات الجمراين

- 1 **Livability**
catering a wide range of intrests

- 2 **Human centric**
Place for individuals amd community

Site Analysis

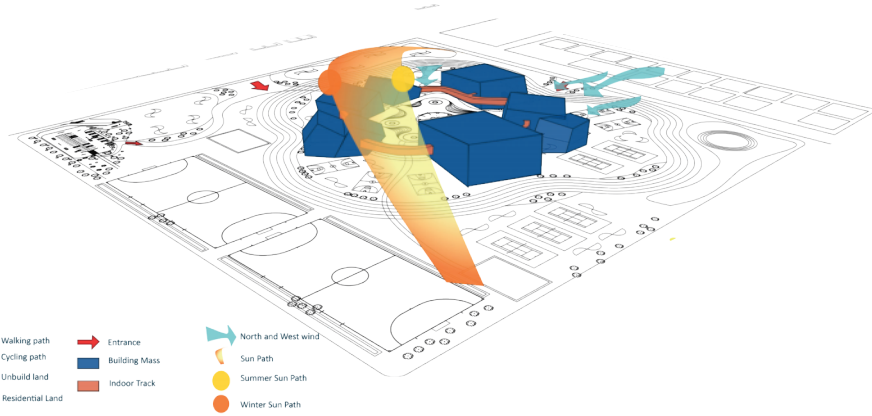

Site Studies

- Wind Study**
southwestern winds
- Sun Study**
maximum heat above 35
- Humidity Study**
High humidity

Location

Global context

Jeddah entered the 2022 list of sports cities in the world [1]. The percentage of sports practitioners from the Makkah region is the highest in Saudi Arabia [3]

Makkah region



Jeddah city



Site Activities

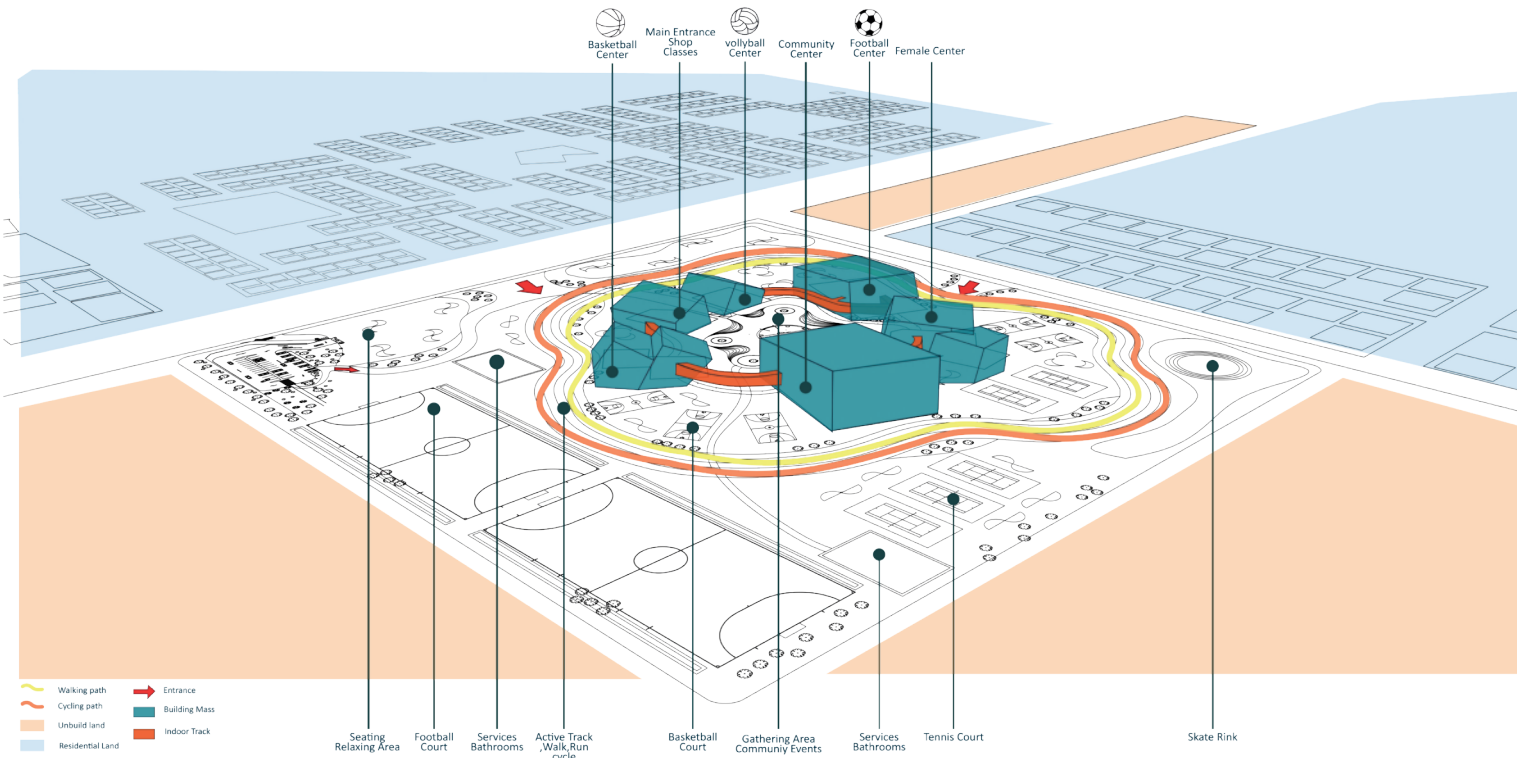

Stratigies

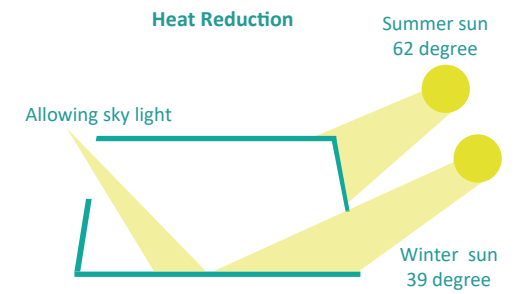
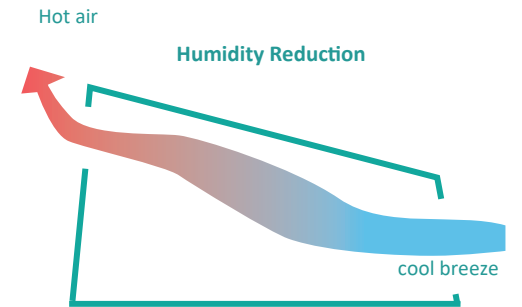

Zoning - Access

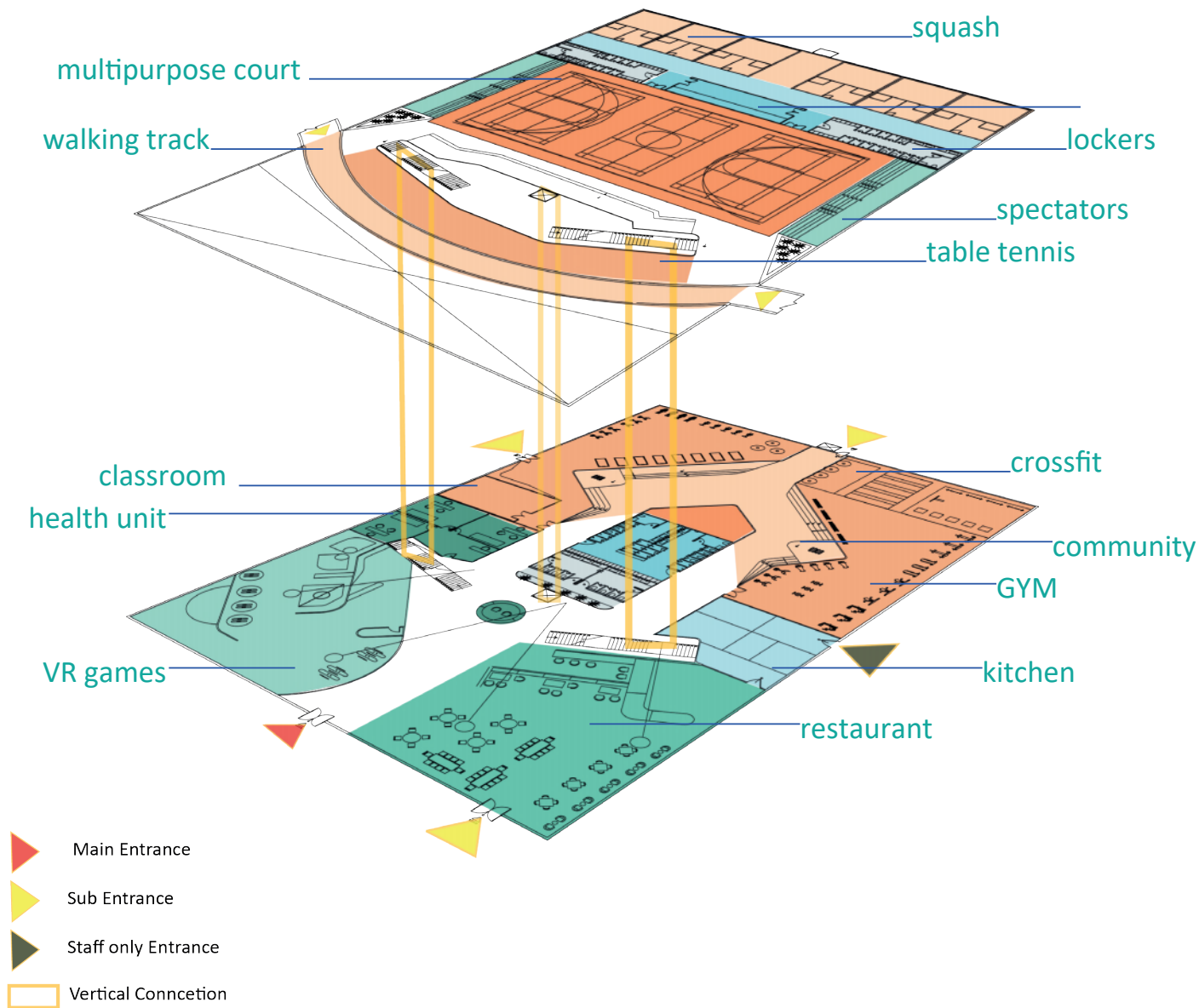

Activities

Main Activities:		Sub Activities:		Services:		
Public	Multipurpose court	19%	Reception	2%	Changing and lockers	12%
	Community space	5%	Restaurant	9%	Bathrooms	2%
	Table tennis	2%	Spectators	3%	Equipment storage	2%
Members	Squash courts	7%	Health follow-up unit	5%	Cleaning storage	2%
	GYM	20%	Virtual sports games	8%	Kitchen storage	2%

Bubble diagram

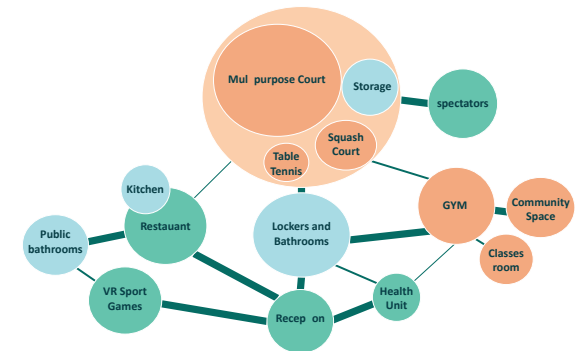

Concept

The connection between humans and sports is about the principle of living in the moment, And we relate this to the connection between people in a community regardless of all the differences. By creating an experience that encourages people to connect with themselves and others, they will live the moment at its fullest.



Connection



Having fun

Materials



Teak wood sheet



Washed wood

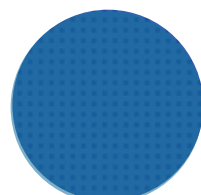

Aluminum mesh

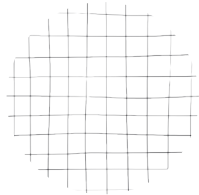

Net fabric

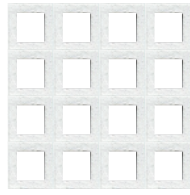

Breeze blocks



acoustic panels



Rubber track



Terrazo



Acrylic

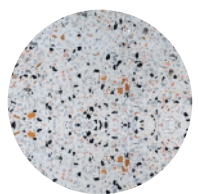

Terrazo

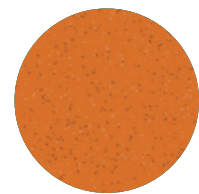

Rubber surface

Mood board



Ground Floor Plan

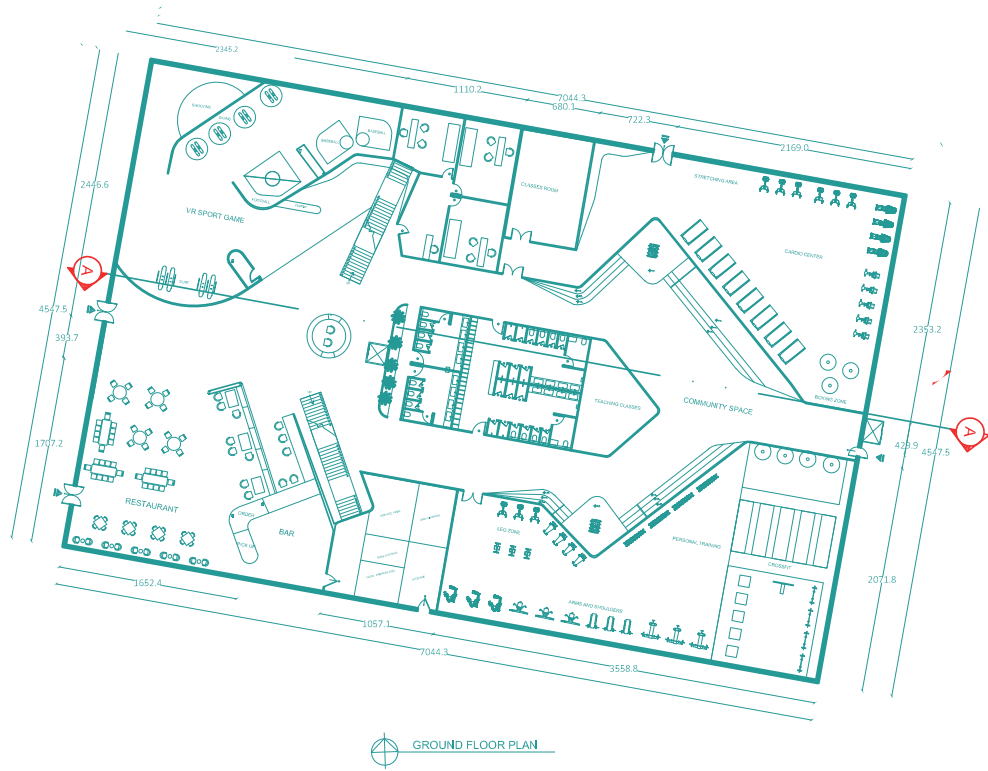

First Floor Plan

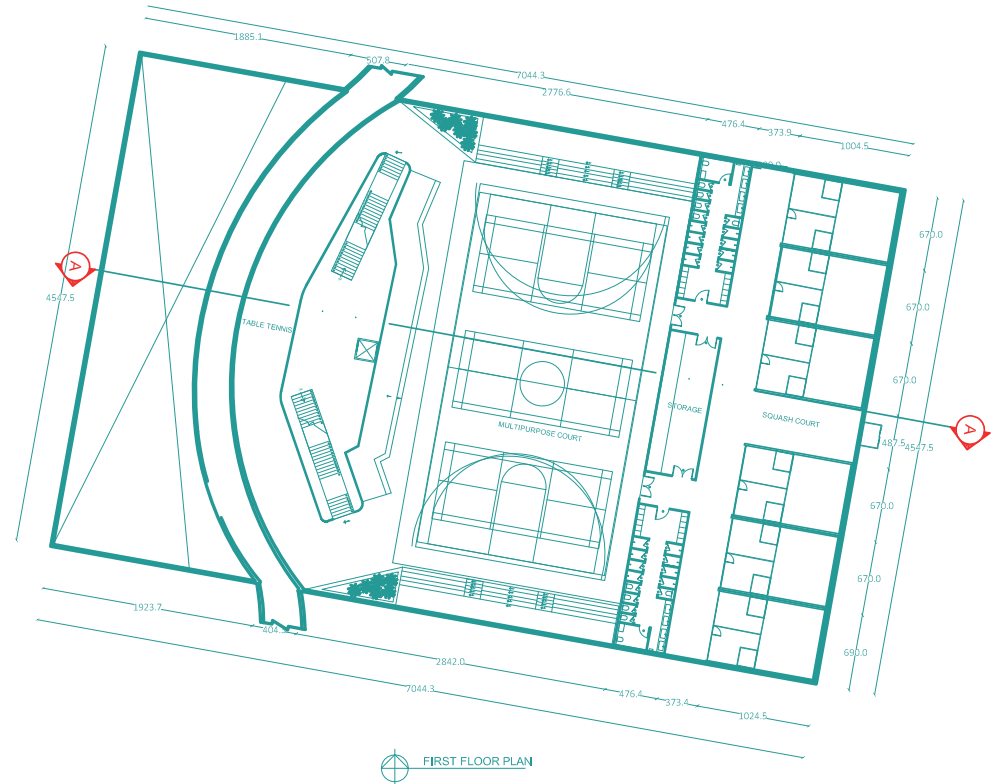





The materials allow air to flow through the space to decrease humidity



Design to make the ceiling feels shorter using human scale



LOC. 10 VISIT. 7

lighting is designed to illuminate the space equally

Multipurpose court



Focusing on the players seating areas drive eyes to them



DESIGNER
WEBSITE



DESIGNER
PROTFOLIO

KING ABDULAZIZ UNIVERSITY
FACULTY OF HUMAN SCIENCE
AND DESIGN

INTERIOR AND
FURNITURE DESIGN
ACADEMIC YEAR: 2021/2022

RAHAF KHALID ALGHAMDI

CONTACT:

EMAIL: RAHAFKHALIDDESIGN@GMAIL.COM

NUMBER: +966 56520 7613

SOCIAL: RAHAF.JOURNEY